

Cherry

3 Bedroom Semi-Detached House

Plot 60 (shown on the right)

Total Area: 94.2m² / 1014ft²

Ground Floor	M	FT
Living Room	5085 x 4355	16'8" x 14'3"
Kitchen / Dining	4810 x 2710	15'9" x 8'10"

First Floor	M	FT
Master Bedroom	3290 x 2820	10'9" x 9'3"
Bedroom 2	3270 x 2760	10'8" x 9'0"
Bedroom 3	3270 x 2195	10'8" x 7'2"



Ground Floor



First Floor

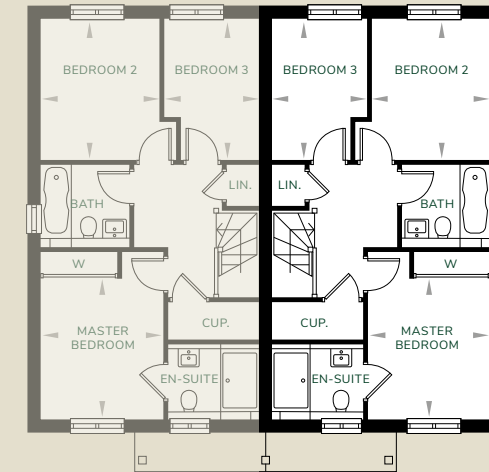

All images and floor plans are for illustrative purposes only and may be changed due to existing building constraints.
All dimensions are indicative and are not to be used for carpet sizes, appliance spaces or items of furniture.