

Blackthorn

Plot 6

3 bedroom semi-detached house

<i>Ground Floor</i>	M	FT
Living Room:	4830 x 4565	(15'10" x 14'11")
Kitchen / Dining:	5000 x 2630	(16'4" x 8'7")

<i>First Floor</i>	M	FT
Master Bedroom:	3650 x 2695	(11'11" x 8'10")
Bedroom 2:	4410 x 2545	(14'5" x 8'4")
Bedroom 3:	3275 x 2160	(10'9" x 7'1")



Total Area
93.4m² 1005ft²

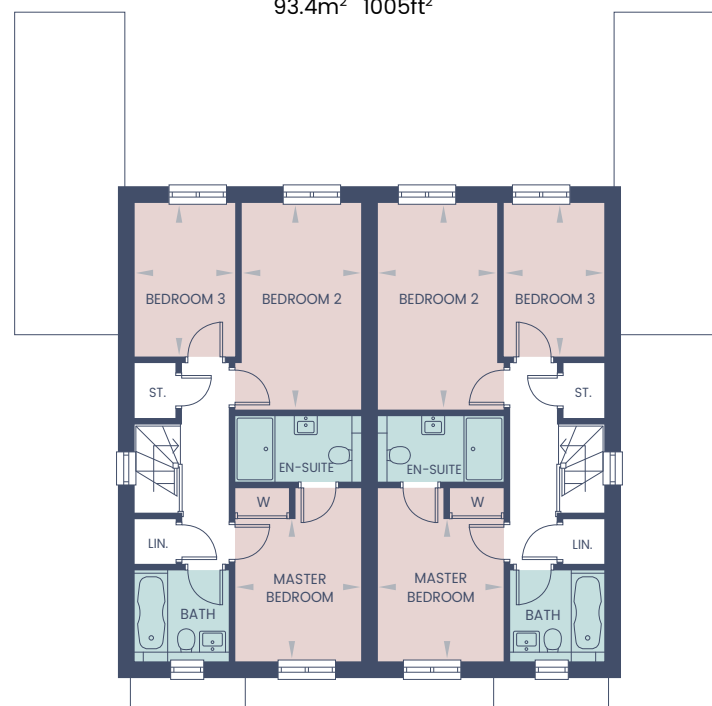
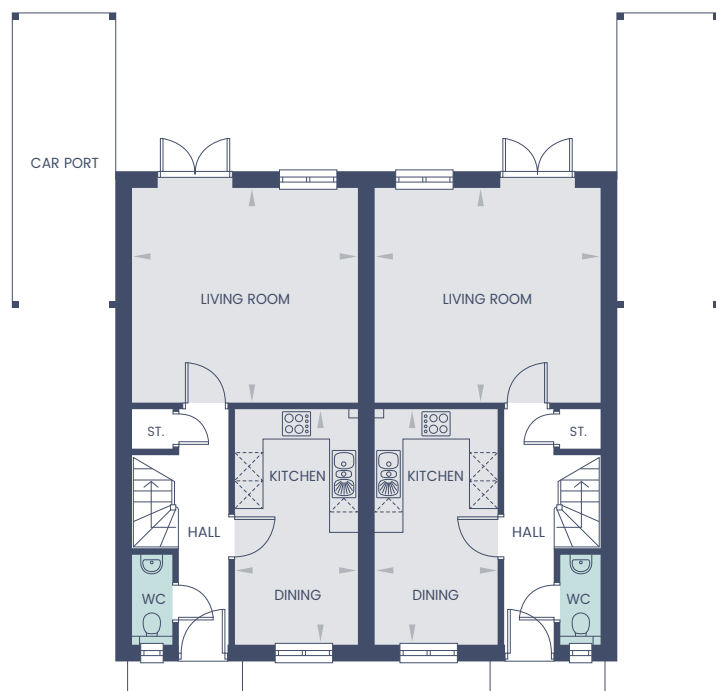

All images and floor plans are for illustrative purposes only and may be changed due to existing building constraints.
All dimensions are indicative and are not to be used for carpet sizes, appliance spaces or items of furniture.