

# Blackthorn

## Plot 5

3 bedroom semi-detached house

Ground Floor	M	FT
Living Room:	4830 x 4565	(15'10" x 14'11")
Kitchen / Dining:	5000 x 2630	(16'4" x 8'7")

First Floor	M	FT
Master Bedroom:	3650 x 2695	(11'11" x 8'10")
Bedroom 2:	4410 x 2545	(14'5" x 8'4")
Bedroom 3:	3275 x 2160	(10'9" x 7'1")



Computer Generated Image



Total Area  
93.4m<sup>2</sup> 1005ft<sup>2</sup>

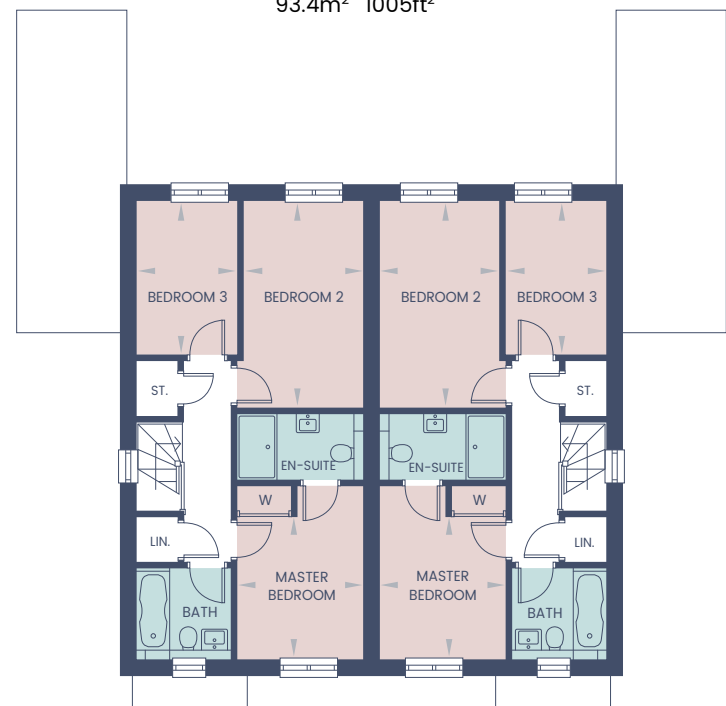
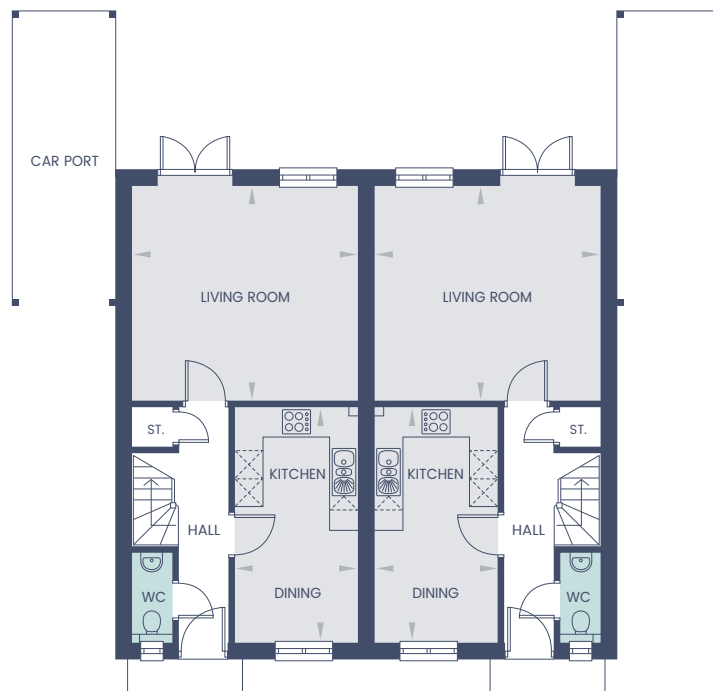

All images and floor plans are for illustrative purposes only and may be changed due to existing building constraints.  
All dimensions are indicative and are not to be used for carpet sizes, appliance spaces or items of furniture.